



Flush Mount Electronic Transmitter Pressure and Level

PT 12 Series



- 0.25% FS Accuracy
- Standard Ranges 0-5 to 0-150 psig
- Flush mount, fits 1" PMC Nipple
- -5° to +175°F operating
- Fast Delivery

The PMC Flush Mount Electronic Transmitter model PT12 Series is designed to accurately measure pressure and level in processes where clogging of the diaphragm face is of particular concern. The small 1" diameter transmitter permits installation flush with the inside wall of pipes 2" in diameter and larger. This feature eliminates any build-up of solids often encountered with conventional flange mount and recessed diaphragm type pressure transmitters. The PT12 Series incorporates a high precision ceramic capacitive pressure sensor to ensure accuracy and durability. This type of sensor is ideally suited for high wear applications. The process pressure is converted to a standard 2-wire, 4-20 mA output via either a PVC cable or micro DIN electrical connection.

The PT12 Series is offered as a fixed range transmitter in 7 standard full scale gauge pressure ranges from 0 – 5 to 0 – 150 psi. For intermediate ranges, ranges specified in other engineering units, i.e. inches H₂O, and full scale ranges from 1 psi to 300 psi, please refer to model PT10 Series

The PT12 Series has been designed specifically for installation into the patented PMC 1" Nipple which is available either in a weld-on or screwed-in format

Pneumatic Versions Also Available

STANDARD SPECIFICATIONS

■ Full Scale Ranges

0-5, 0-15, 0-30, 0-60, 0-100 and 0-150 psig

■ Static Accuracy

± 0.25% of Full Scale
Combined non-linearity, hysteresis, and repeatability

■ Overpressure

4X for 5 psi range
1.5X for all other ranges

■ Compensated Temperature Range

-5°F to 175°F (-20°C to 80°C)

■ Operating Temperature Range

Ambient: -5°F to 175°F (-20°C to 80°C)

■ Temperature Effects

Thermal Zero Shift: $\lt; \pm 0.04\%/^{\circ}\text{F}$
Thermal Span Shift: $\lt; \pm 0.02\%/^{\circ}\text{F}$
For 5 psi range, Temperature Effects are typically prorated from 15 psi, i.e. 3 x greater

■ Electrical

Output: 2-wire, 4-20 mA
Supply Voltage: 10-32 VDC

■ Zero Setting

± 1% FS

■ Span Setting

± 1% FS

■ Long Term Stability

± 0.1% Full Scale typical

■ Electrical Termination

CV/P - 10' PVC Cable
CV/M - Micro DIN 40050

ORDERING INFORMATION

PT12 Series Flush Mount Electronic Transmitter Pressure and Level

When ordering please specify the following:

MODEL PMC - PT 12	
Range	Specify psi
Termination	
CV/P	10' PVC cable
CV/M	Micro DIN connector
Nipples	
PT-07	Weld-on 316L SS
PT-07S	NPTM 1" 316L SS

(1) (2) (3) (4)
Specify Specify Specify Specify-if required

Order Code Example: PMC-PT12-15psig-CV/P-PT-07

- (1) Model: PMC-PT12
- (2) Range: 15 psig
- (3) Termination: 10' PVC Cable
- (4) Nipples: Weld-on 316L SS

OPTIONS

PMC offers a comprehensive range of electronic and pneumatic pressure transmitters with various terminations, displays and submersible options. Please contact the factory or go to www.pmc1.com for further information.

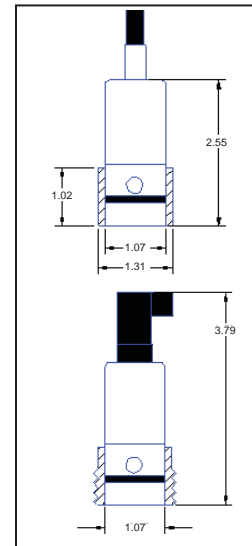

All measurements shown in inches

PMC adopts a continuous development program which sometimes necessitates specification changes without notice.

HEAD OFFICE



Process Measurement & Controls, Inc.

11 Old Sugar Hollow Road
Danbury, CT 06810 U.S.A.

Tel: 203-792-8686

Fax: 203-743-2051

Email: sales@pmc1.com

www.pmc1.com

Represented By: